

STEP 5

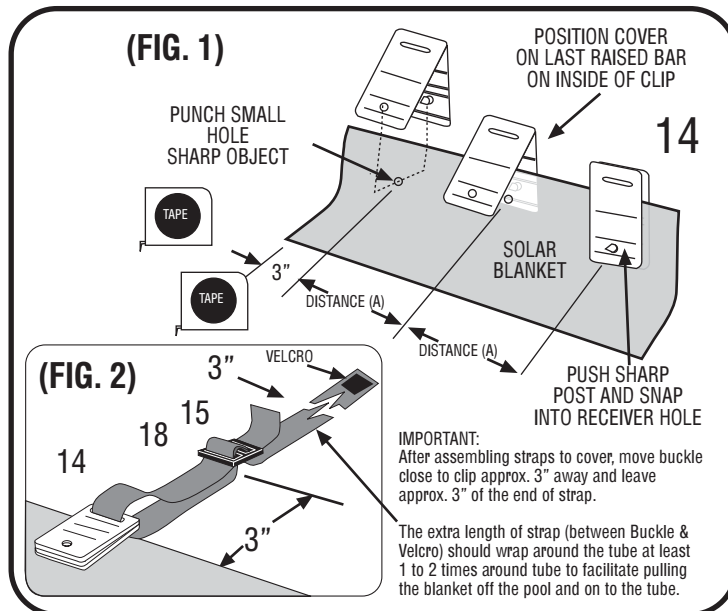

STEP 5: Assemble Cover Clip (10) as shown in drawing (FIG.1) to the pool cover equally spaced as per drawing in previous page (SEE STEP 4). Assemble and attach cover strap (14) with Buckle (11) to attached cover clip (FIG. 2).

STEP 7

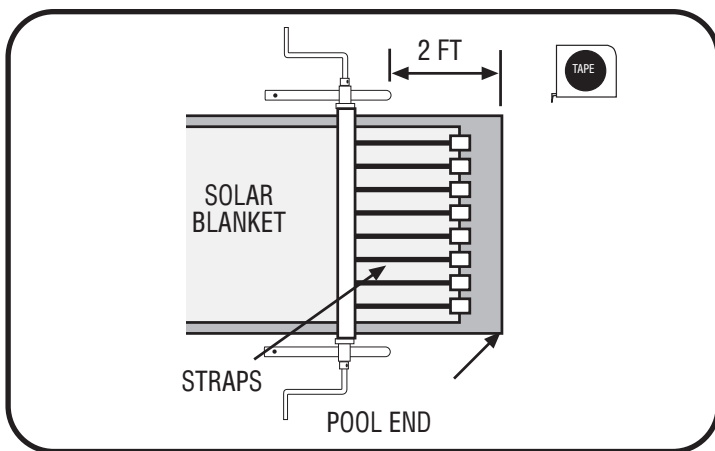

STEP 7: Roll the reel system so that it straddles the pool, and is 2 ft from end of pool as in drawing. More distance may be required for irregular pools. If your pool IS NOT rectangular shape, merely fold the cover in the irregular areas back on itself so that the entire pool cover can pass between the two end main frames of the reel assembly.

LIMITED WARRANTY

ODYSSEY SYSTEMS warrants the reel system to be free of workmanship/ material defects for a period of three (3) years from the date of purchase. Any claims must be supported by invoice/proof of purchase. EXCLUDED FROM THIS WARRANTY ARE ALL CONSUMABLES: straps, cord, velcro, plastic plates and clips.

ODYSSEY SYSTEMS WILL not be liable for any incidental or consequential damages resulting from any defects in workmanship or material, nor for personal injury resulting from improper placement of reel system when not in use.

STEP 6

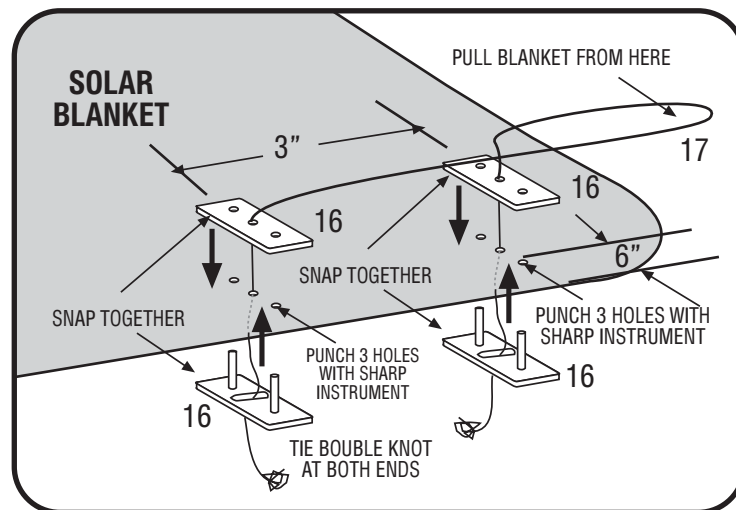

STEP 6: For ease of re-covering your pool after use, install the return cord provided. Locate the plates about **3" apart and at least 6" from the edge of the cover**. To install plates, use the top plate with three holes as a GUIDE to punch three holes with a sharp tool through the cover. Snap the posts on the male bottom plate through the two holes on the top female plate with the cover sandwiched between. Thread the return cord through the **center hole** in both top and bottom plates as shown in the diagram above and then tie a **double knot** at both ends.

STEP 8: Standing behind the tube, place foot or hold base of triangular frame and pull the top of the frame toward you to rotate system into operating position. Rotate handwheel slowly. The straps will move the cover away from possible damage on the coping and fold back into itself. Continued rotation of the hand wheel will transport the cover underneath the tube and then up, over and onto the tube. To recover pool, hold white return cord and walk down the length of the pool, allowing the system to "free wheel" the cover back onto the pool surface. After cover is fully extended unfold irregularly shaped areas.

STEP 8

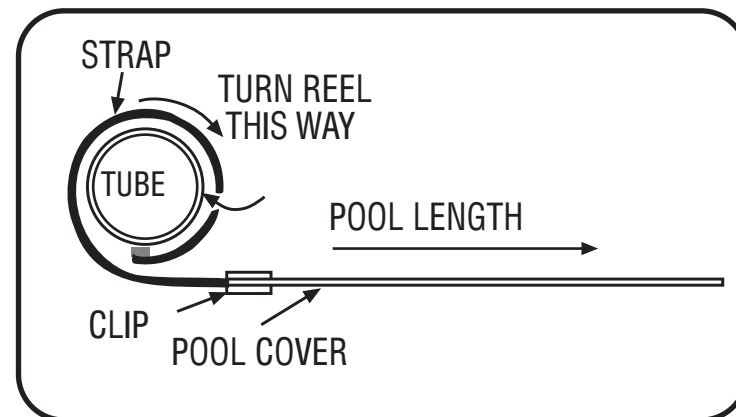

ODYSSEY SYSTEMS

220 South Ola Vista, Suite C, San Clemente, CA 92672
(949) 498-9454 • Fax (949) 361-0608
www.odysseysystems.com

© ODYSSEY SYSTEMS 2005

ODYSSEY SYSTEMS

PARTS LIST

FREEDOM SERIES M500 REEL SYSTEM

Assembly and Operation Instructions
For Solar Covers up to 20' x 45' (Max 12 Mil Thickness)

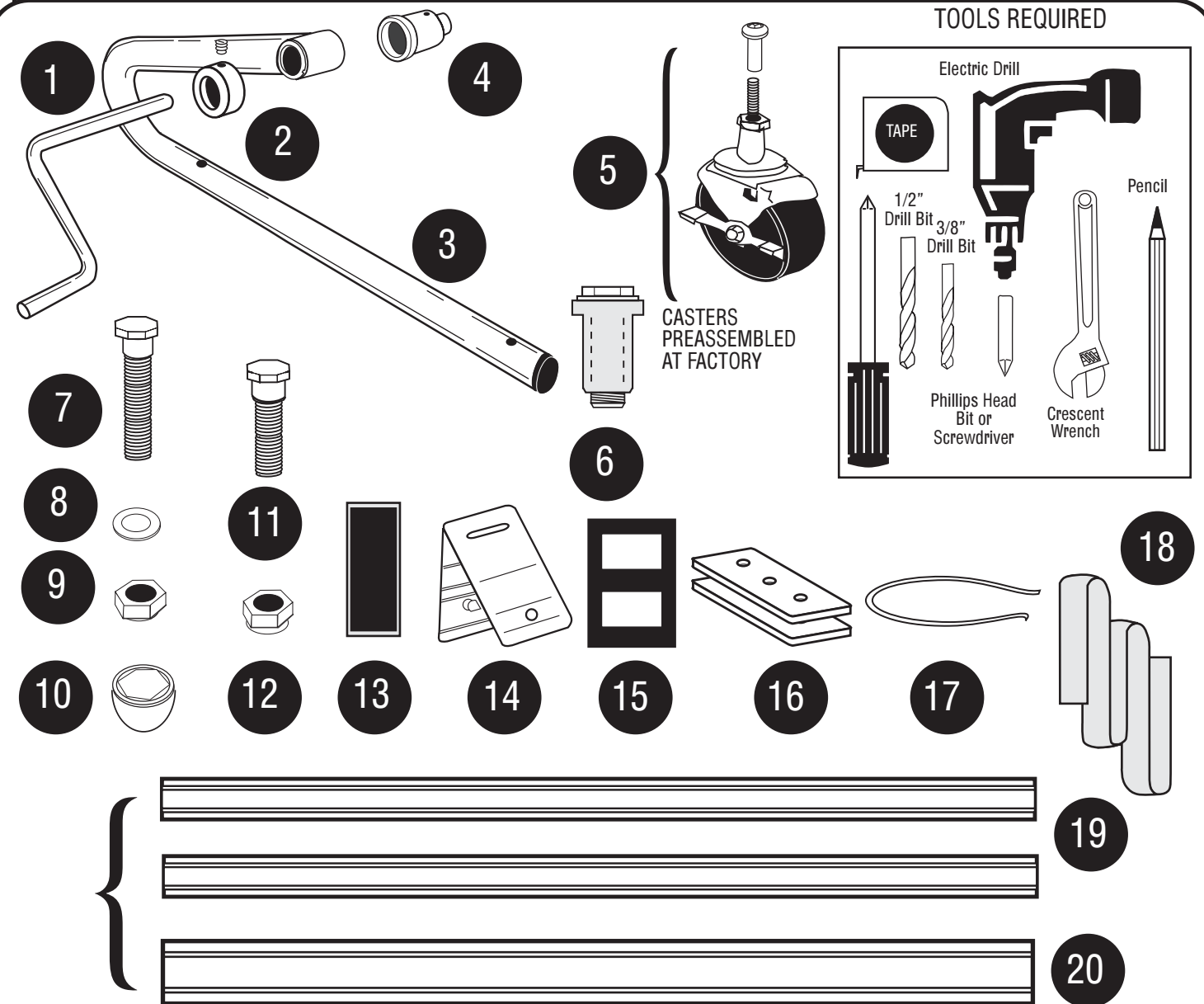

TOOLS REQUIRED

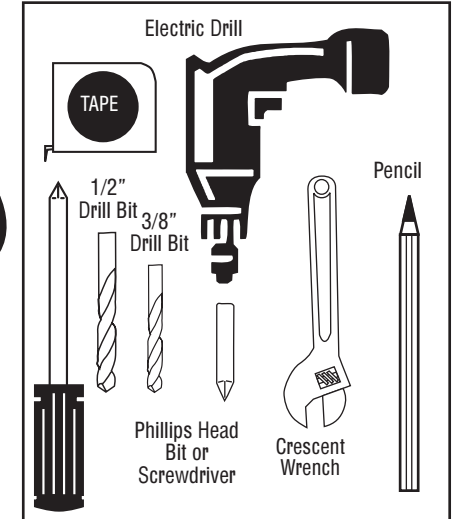

1. Hand Crank	518	2. 11. 3-1/4" Shoulder Bolt	XXX	2
2. Set Collar	519	3. 12. 1/4 - 20 Nylok Nut	445	2
3. Main Frame w/casters	505	4. 13. 1" Velcro Hook,	880	8
4. End Cap	528	5. 14. Quick Clip Cover Plate	600	8
5. 3" Locking Caster Assy	455	6. 15. Strap Buckle	800	8
6. Neoprene Insert	476	7. 16. Cord Plate (Set)	610	2
7. 5/16" x 3-1/4" Hex Head Bolt	XXX	8. 17. 5' Return Cord	840	1
8. 5/16" Nylok Nut	XXX	9. 18. 6' Blue Strap	890	8
9. 5/16" Flat Washer	XXX	10. Aluminum Tube Set	910	
10. Plastic Nut Cap	XXX	11. 19. 8'6" Aluminum Tubes Inner		2
		12. 20. 8'6" Aluminum Tubes outer		1

REEL ASSEMBLY

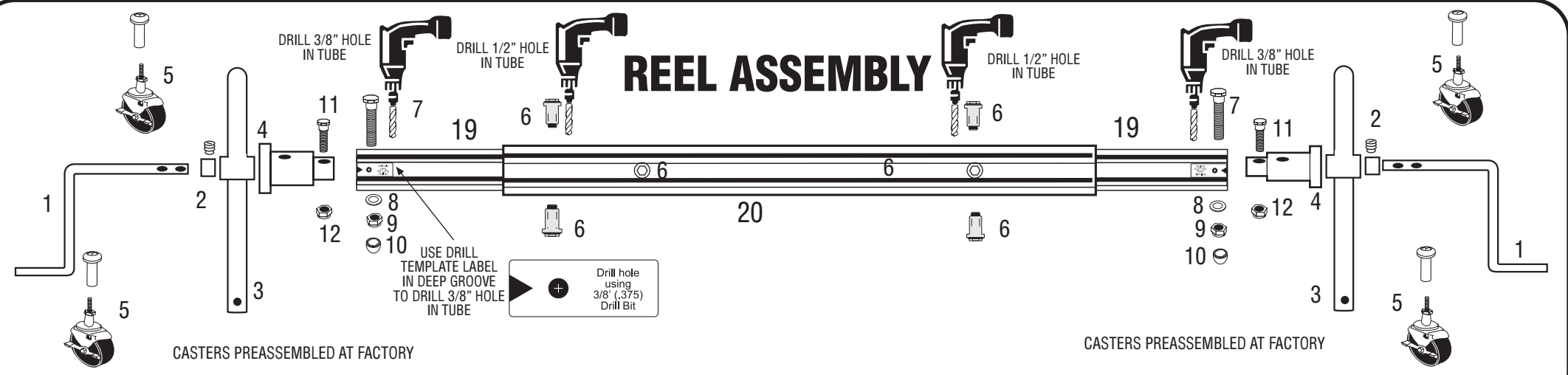

INITIAL PREPARATIONS

1. Prior to assembly, select the most suitable location for the reel, normally 2 feet from either end of the pool. However, on irregular pools, a location closer to the center of the pool may be preferred and at the pools maximum width. Other considerations are obstructions (diving boards, hand rails, etc). When in doubt, consult your dealer or call Odyssey Systems for an evaluation of your reel placement.

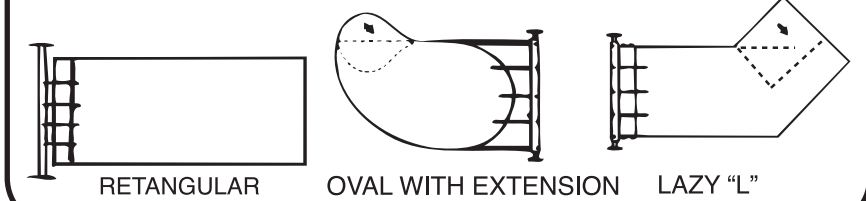

STEP 1

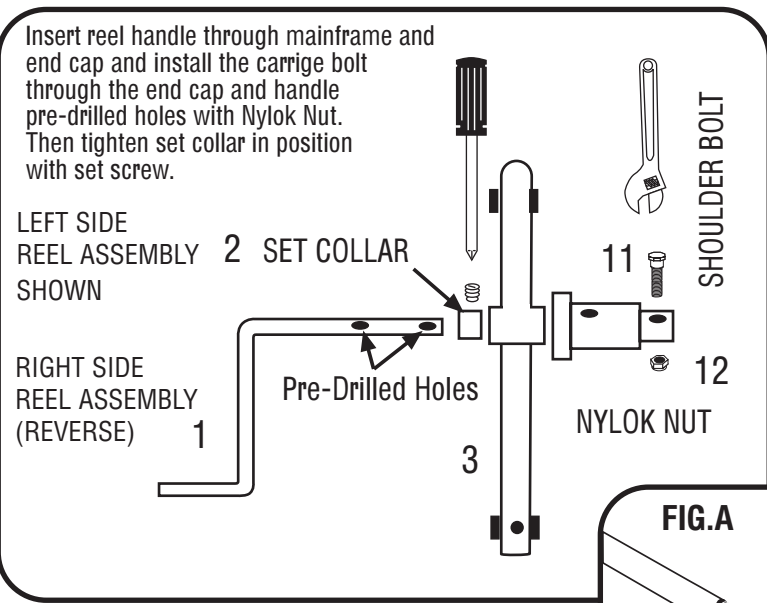

Before start, familiarize yourself with all of the reel parts.

STEP 1: Assemble **BOTH** mainframe assemblies as shown in drawing at left.

STEP 2: Position **BOTH** mainframes at end of pool on pool deck as shown (FIG B). Assemble inner & outer tubes as shown and insert into reel assembly on each side. **Keep minimum measurements in mind as you do this.** Mark inner tubes as shown.

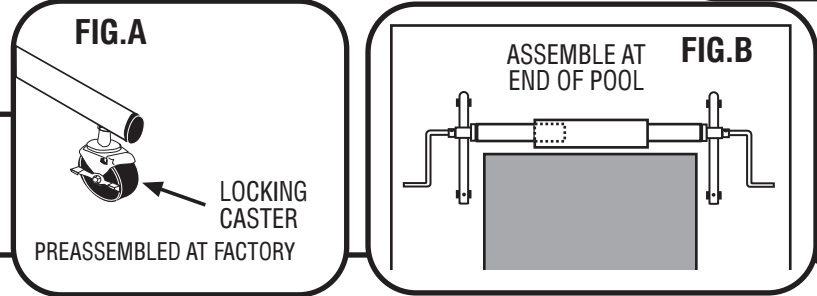

STEP 3

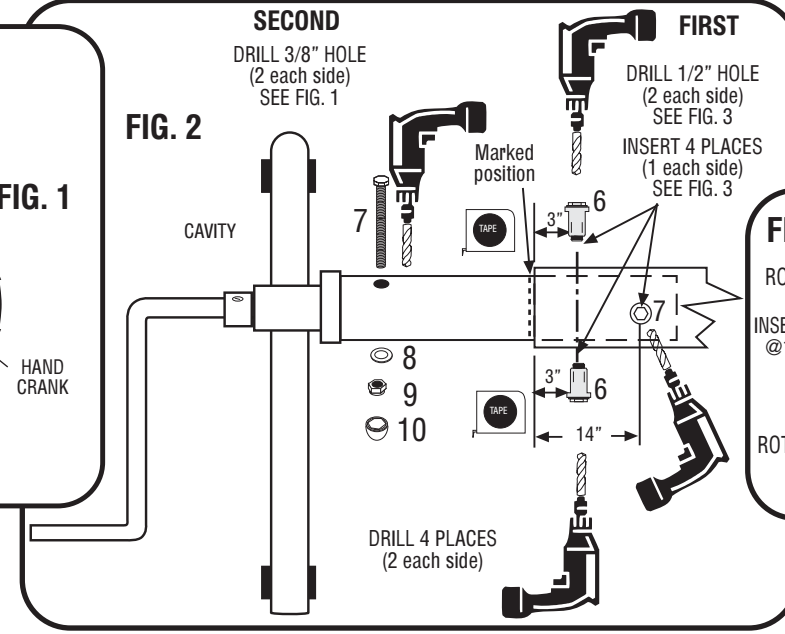

STEP 3:

1. Disassemble tubes from mainframe assemblies and reassemble tubes only, making sure the tubes are in **marked position**.

2. To attach the **LEFT SIDE** of section 1 & 2 tubes. Using FIG. 1 & FIG. 3 as a guide, with a power drill and a sharp 1/2" bit, **DRILL two (2) holes at 3" from the left end of the OUTER tube and in the center of the groove cut in the tube and OPPOSITE of each other. DRILL through BOTH tubes. ROTATE tube 90° and DRILL two (2) more holes through BOTH tubes at 14" from same edge and in the center of groove cut also and again OPPOSITE from each other.**

3. Place neoprene tube inserts (7) into the drilled 4 holes (SEE FIG. 3). Using a crescent wrench, insert and semi-tighten all four inserts by **ONLY** giving them **two (2) complete turns each** in clockwise rotation starting with **Insert 1** which is at 3" form edge of tube, ending with **Insert 4** which is at 15".

4. Starting again with **Insert 1**, tighten each hex head in **same rotation, two (2) additional complete turns.**

5. Continue to rotate tubes and tighten all hex heads until all are tight and neoprene insert body **mushrooms. Do not over tighten.** (SEE FIG. 3) Now assemble **RIGHT SIDE** of tubes the same way.

6. **MOUNTING TUBES TO END CAP:** Place both mainframes and tube assemblies in a suitable location near pool. Drill 3/8" hole through both sides of outer tube as shown on **drill template label**. Slide **both ends** of the tubes over each end cap, **ALIGNING the DEEP GROOVE** with the same on **BLUE END CAP.**(Refer to FIG. 1). Align holes and insert 3-1/4" bolt (7), add/tighten lock nut (8) and cover nut with plastic cap.

STEP 2

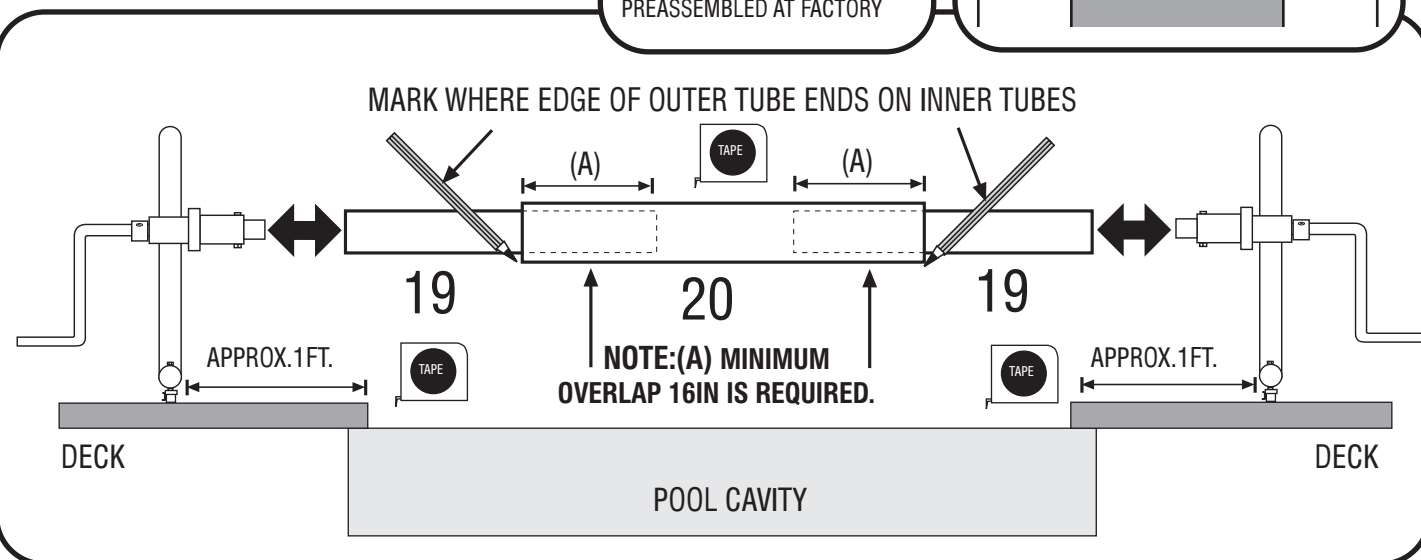

STEP 4

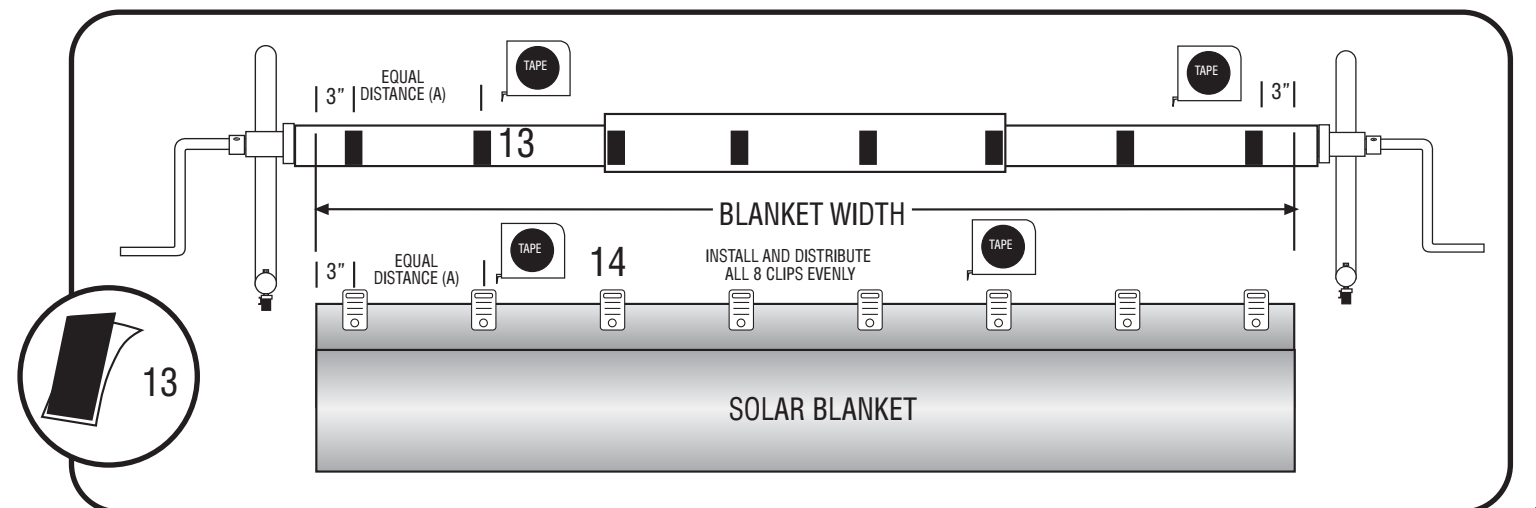

STEP 4: Lay cover next to assembly as shown below. Attach velcro strip (13) to mounted tubes equally spaced as per drawing. Attach Cover Clip (14) to Solar blanket equally spaced as per drawing. Refer to **STEP 5** on next page for clip to cover assembly.